

6.2mm (.244") Pitch Wire-to-Wire L Connector/Terminal

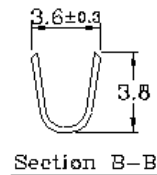
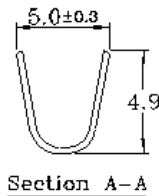
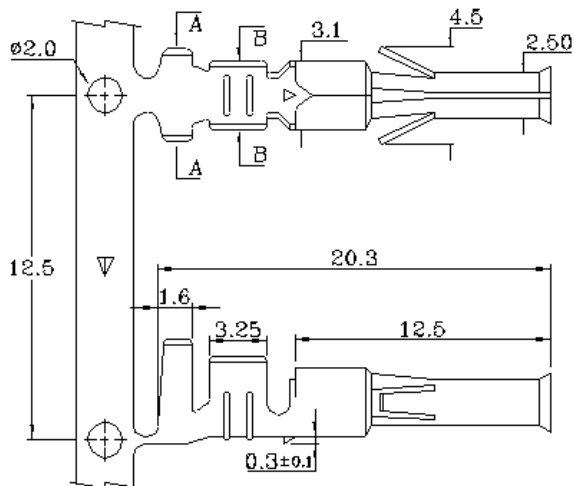

Specifications & Ordering Information

Part No	Thickness	Material	Wire Range	Insulation O.D.	Finish	Qty/reel	Use with	Mates with
2715BS-5	0.25	Brass	AWG #14-18	3.5-2.8 mm	Gold-Flash	4,000	H715-N Housing	2714
2715BS-6	0.25	Brass	AWG #14-18	3.5-2.8 mm	Pre. Tin-Plated	4,000		2717

REV.	DATE	REV.	DATE	<p><b>HO CHIEN</b> www.hochien.com</p>	UNIT : mm	APPROVAL	CHECKED	DRAWING	PRODUC
A	3.24.1999				TOLERANCE : .000 : $\pm 0.08$ .00 : $\pm 0.13$ .0 : $\pm 0.25$				