

REVISION	DESCREPTION	DATE	APPD
0	SET UP	NOV/29/2005	C.Y.LIN

2232S - □

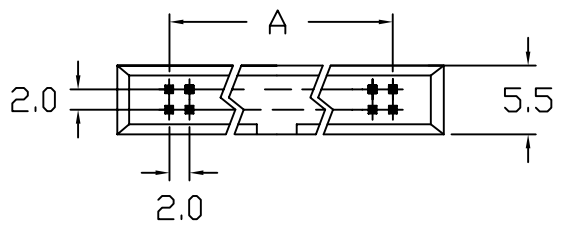

2232R - □

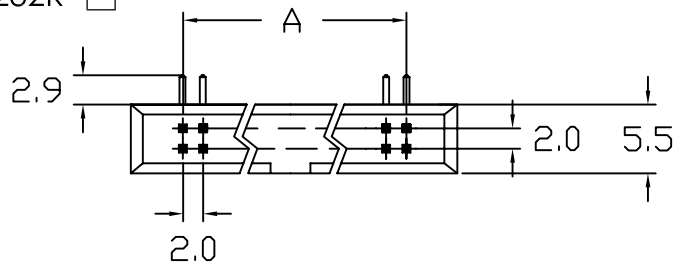

Dimension (mm) Tolerance : ±0.2		
Position	A	B
10	8.0	17.1
12	10.0	19.1
14	12.0	21.1
16	14.0	23.1
18	16.0	25.1
20	18.0	27.1
22	20.0	29.1
24	22.0	31.1
26	24.0	33.1
28	26.0	35.1
30	28.0	37.1
32	30.0	39.1
34	32.0	41.1
36	34.0	43.1
40	38.0	47.1
44	42.0	51.1
50	48.0	57.1
60	58.0	67.1
64	62.0	71.1
68	66.0	75.1

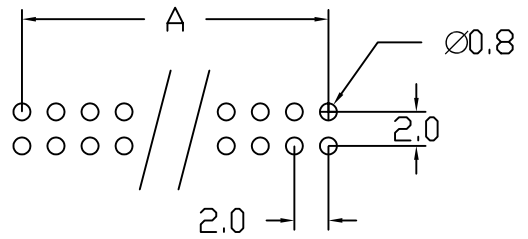
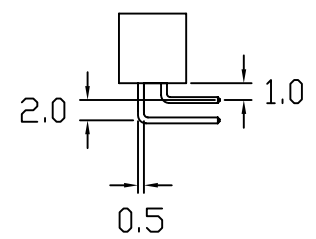
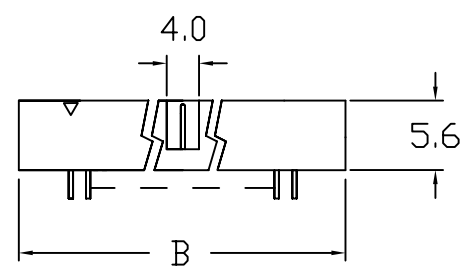
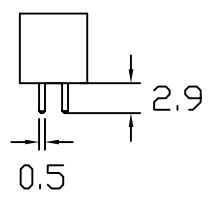
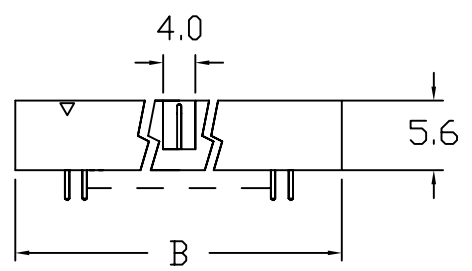

P.C. Board Layout

MATERIAL & ELECTRICAL
 INSULATOR : Nylon 6T UL 94-V0
 CONTACT : Brass
 PLATING : Gold plated over Nickel
 CURRENT RATING : 1 Amps
 CONTACT RESISTANCE : 20mΩ max. at DC 100mA
 INSULATOR RESISTANCE : 5000MΩ min. at DC 500V
 OPERATING TEMPERATURE : -40°C ~ +105°C

TYPE
 S=Straight
 R=Right Angle
 M=S.M.T.
NO. OF CONTACT
 10 ~ 68 pos
 * Black color only

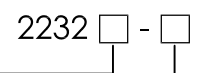

TITLE: 2.00mm CENTER SHROUDED HEADER	
PAGE: 1 OF 1	HO CHIEN P/N. 2232 SERIES

DR: RON CHEN	CHK: J.T.CHEN	APPD: C.Y.LIN
-----------------	------------------	------------------

HO CHIEN P/N. 2232M - □

REVISION	DESCREPTION	DATE	APPD
0	SET UP	NOV/29/2005	C.Y.LIN

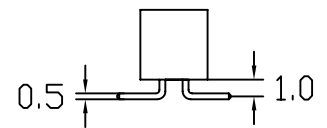
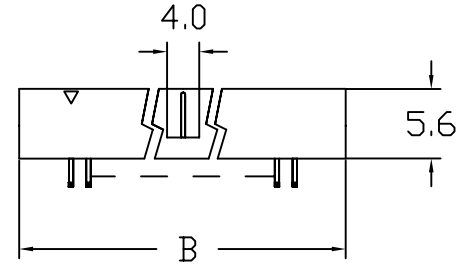
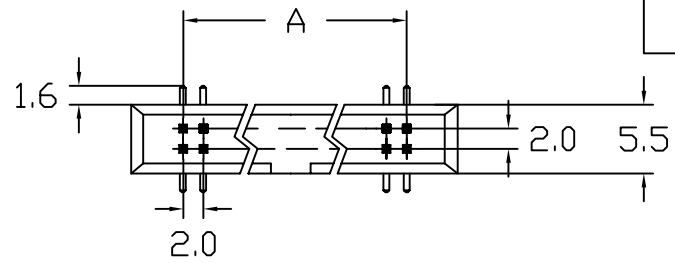
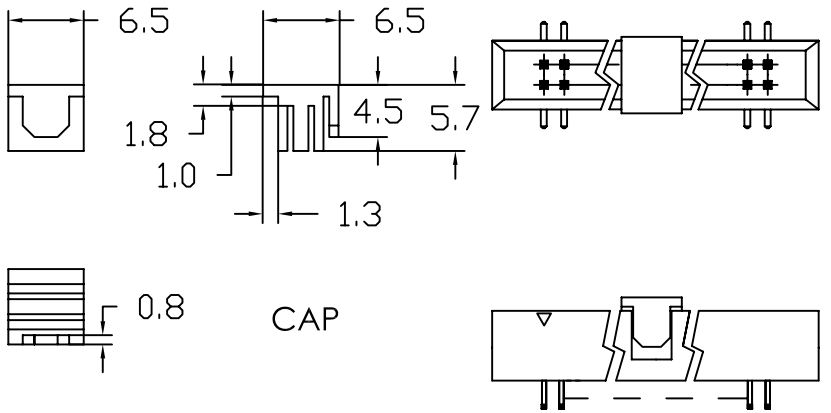

Dimension (mm)
Tolerance : ±0.2

Position	A	B
10	8.0	17.1
12	10.0	19.1
14	12.0	21.1
16	14.0	23.1
18	16.0	25.1
20	18.0	27.1
22	20.0	29.1
24	22.0	31.1
26	24.0	33.1
28	26.0	35.1
30	28.0	37.1
32	30.0	39.1
34	32.0	41.1
36	34.0	43.1
40	38.0	47.1
44	42.0	51.1
50	48.0	57.1
60	58.0	67.1
64	62.0	71.1
68	66.0	75.1

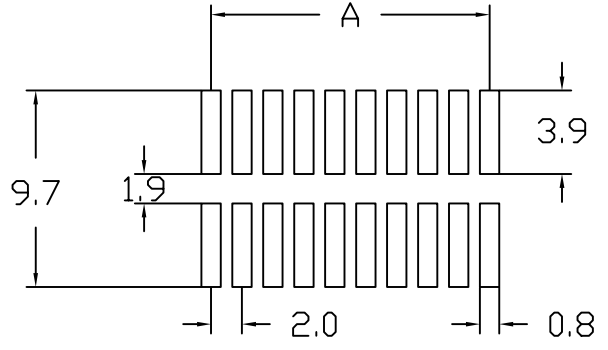

P.C. Board Layout

MATERIAL & ELECTRICAL
 2232S - □ & 2232R - □ 2232M - □
 INSULATOR : Nylon 6T UL 94-V0 INSULATOR : Nylon 6T UL 94-V0
 CONTACT : Brass CONTACT : Phosphor bronze
 PLATING : Gold plated over Nickel
 CURRENT RATING : 1 Amps
 CONTACT RESISTANCE : 20mΩ max. at DC 100mA
 INSULATOR RESISTANCE : 5000MΩ min. at DC 500V
 OPERATING TEMPERATURE : -40°C ~ +105°C

2232M - □ □

TYPE _____
 S=Straight
 R=Right Angle
 M=S.M.T.

NO. OF CONTACT _____
 10 ~ 68 pos

STANDARD PACKING _____
 Blank=TRAY
 CT=CAP+TUBE
 CR=CAP+TAPE REEL
 * Black color only



TITLE : 2.00mm CENTER SHROUDED HEADER

PAGE: 1 OF 1 HO CHIEN P/N. 2232M - □

DR: RON CHEN CHK: J.T.CHEN APPD: C.Y.LIN