

REVISION	DESCREPTION	DATE	APPD
0	SET UP	MAR/17/2000	C.Y.LIN

2532

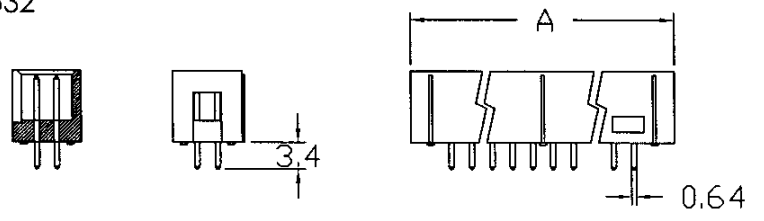

2533

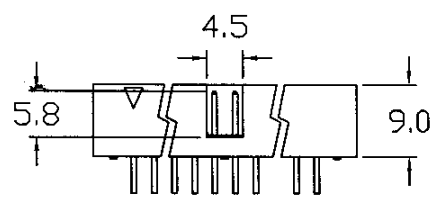
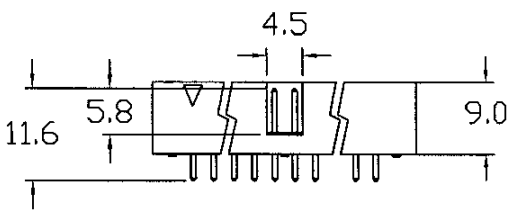
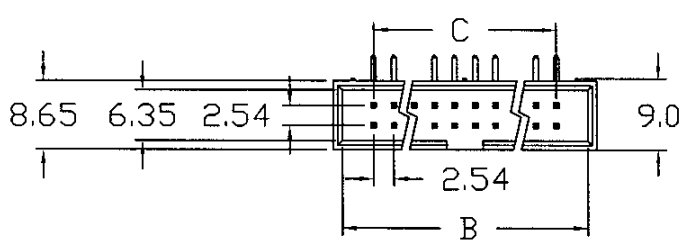
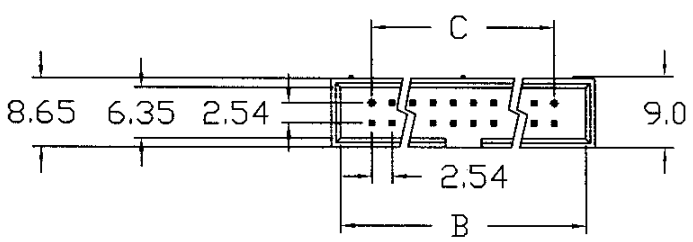
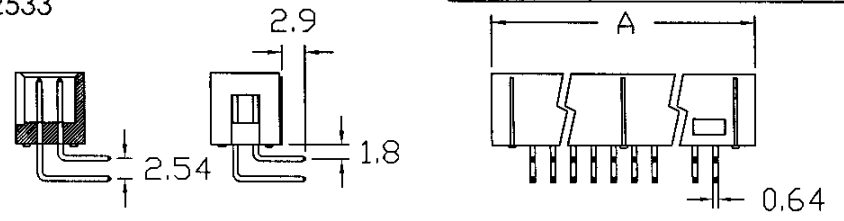

Dimension (mm)
Tolerance : ± 0.2

Position	A	B	C
10	20.34	18.10	10.16
14	25.48	23.18	15.24
16	27.90	25.72	17.78
20	33.05	30.80	22.86
24	38.08	35.88	27.94
26	40.68	38.42	30.48
30	45.70	43.50	35.56
34	50.80	48.58	40.64
40	58.46	56.20	48.26
50	71.10	68.90	60.69
60	83.80	81.60	73.66
64	89.10	86.68	78.74

TYPE
2=Straight
3=Right Angle
NO. OF CONTACT
10 ~ 64 pos
INSULATOR COLOR
Blank=Black
GY=Grey

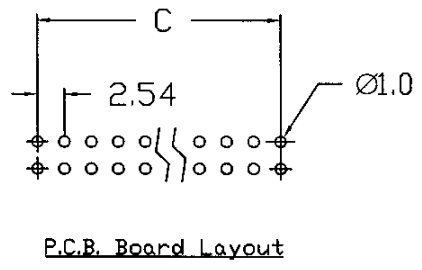
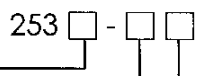

MATERIAL & ELECTRICAL
INSULATOR : P.B.T. +30% Glass fiber UL 94-V0
CONTACT : Brass
PLATING : Gold plated over Nickel
CURRENT RATING : 1 Amps
CONTACT RESISTANCE : 20mΩ max. at DC 100mA
INSULATOR RESISTANCE : 5000MΩ min. at DC 500V
OPERATING TEMPERATURE : -55°C ~ +105°C

 **HO CHIEN ENTERPRISE CO. LTD**

TITLE:
0.1"(2.54mm) BOX HEADER CONNECTOR

DR: RON CHEN	CHK: J.T.CHEN	APPD: C.Y.LIN	PAGE: 1 OF 1	HO CHIEN PIN NO. 2532 & 2533
--------------	---------------	---------------	--------------	------------------------------