

SCJ369 SERIES

Dimension (m/m)

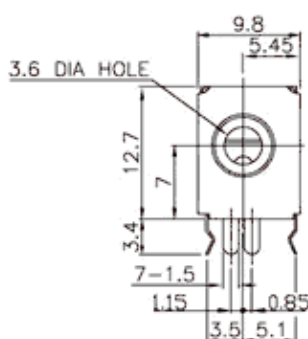

WITH or WITHOUT THREAD

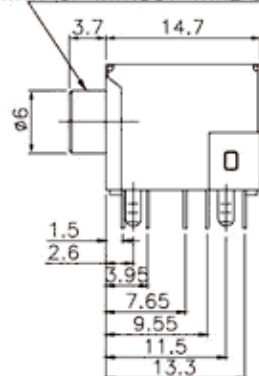

Pin Hole Layout (Jack Bottom View)

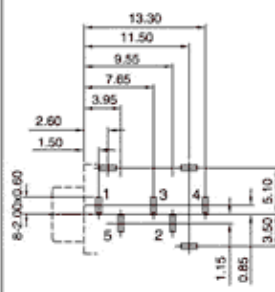

SCJ 369M0****21
SCJ 379M0****21

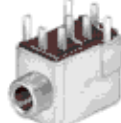

SCJ 369M1****31
SCJ 379M1****31

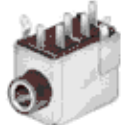

SCJ 369R0****23
SCJ 379R0****23

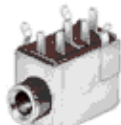

SCJ 369R1****33
SCJ 379R1****33

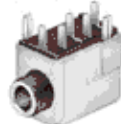

SCJ 369R4****25
SCJ 379R4****25

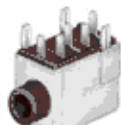

SCJ 369P0****35
SCJ 379P0****35

Schematic Code

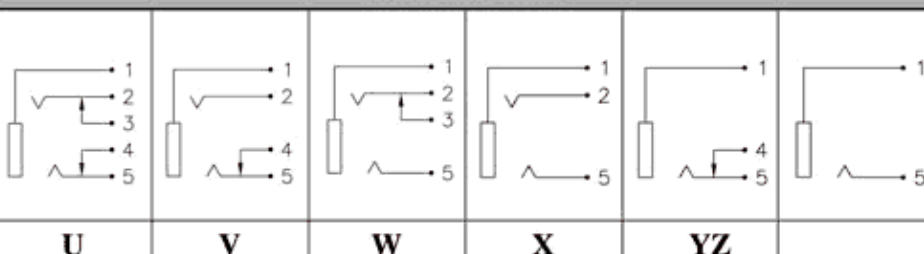

No.	Typical series No.	Metal Shell	Solder Tail Option	
1	SCJ369****21 SCJ379****21	2 Pin	Flat type	IU
2	SCJ369****31 SCJ379****31	3 Pin		
3	SCJ369****23 SCJ379****23	2 Pin	Kink type	KIU
4	SCJ369****33 SCJ379****33	3 Pin		
5	SCJ369****25 SCJ379****25	2 Pin	Hook type	IKU
6	SCJ369****35 SCJ379****35	3 Pin		

Feature

The SCJ369/SCJ379 series is designed for space saving type (width 9.8 mm with metal shell) and can be available with 5 terminals.

Construction

- Housing : Thermoplastic
- Terminal : Brass / Phosphor bronze

Specification

- Withstanding voltage :
AC 500V, 60Hz for 1 minute
- Insulation resistance :
100MΩ (min.) at 500V DC
- Contact resistance :
30mΩ (max.)
- Insertion & Extraction force :
Initial : 0.4 to 2.0kgs
After life test : 0.3 to 2.0kgs
- Life test :
5,000 cycles unloading (20-30 cycles/minute)
- Humidity test is kept in 90-95%(RH) for 96 hours.

Ordering Information

SCJ369 □□ □□ □□ □□ □□ □□ □□
① ② ③ ④ ⑤ ⑥ ⑦ ⑧

- Series No. SCJ369 shell Tin/lead, SCJ379 shell Nickel
- Bushing type (See page B-4)
M0, M1, R0, R1, R4, P0
- Bushing or metal ring plating
N : Nickel ("N" is standard)
G : Gold flash
0 : No plating (fully plastic bushing)
- Schematic code no.:
U, V, W, X, Y, Z
- Terminal plating ("S" is standard)
T : Tin S : Silver G : Gold flash
- Nut option : (See page B-5 for details)
0 : Without nut
1 : With round type nut (M6 × P0.5)
2 : With hexagonal nut (M6 × P0.5)
- Housing color option ("B" is standard)
B : Black U : Blue R : Red
I : Beige G : Green A : Gray
Other colors option are available
- Metal shell solder tail option (see photos)
21, 31, 23, 33, 25, 35