

REVISION	DESCREPTION	DATE	APPD
0	SET UP	OCT/30/2006	C.Y.LIN

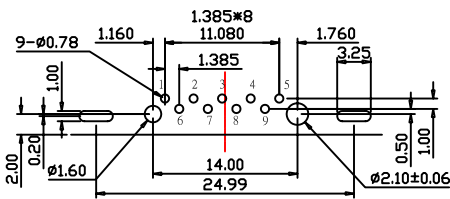

P.C.Board Layout

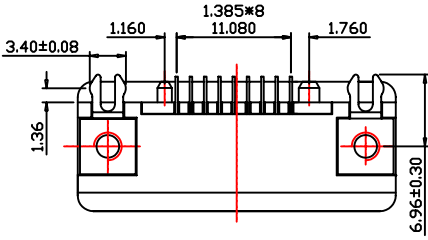
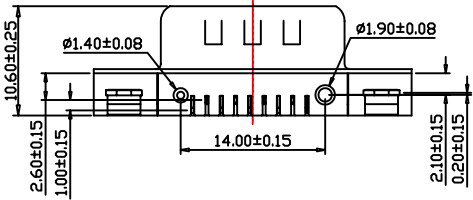
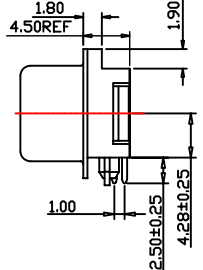
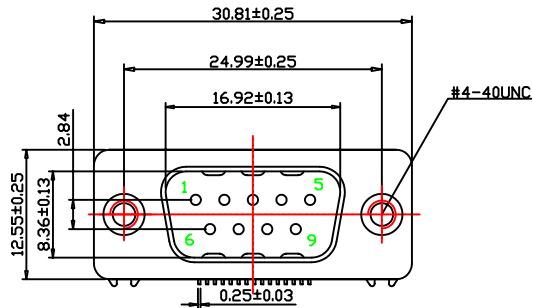
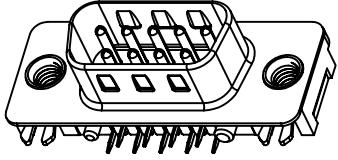

UNIT : mm
Tolerance : ± 0.2

3013S - [] [] [] [] [] []

CONTACT TYPE

- 0=MALE
- 1=FEMALE

NO. OF CONTACT

- 1=9Pin
- 2=15Pin
- 5=25Pin
- 6=37Pin
- 7=60Pin

CONTACT PLATING

- Blank=Gold Flash Selective Gold Plating
- E=15U" Selective Gold Plating
- D=30U" Selective Gold Plating

PLATING OF SHELL

- Blank=Nickle Plating
- T=Tin Plating

INSULATOR COLOR

- Blank=Black
- B=Blue
- G=Green

MOUNTING OPTION

- Blank=Riveted W/2-Prong Boardlock #4-40 unc Threaded Hole
- EN=Riveted W/4-Prong Boardlock #4-40 unc Threaded Hole
- 2J=Riveted W/2-Prong Boardlock #4-40 unc Screwlock Fixed
- 4J=Riveted W/4-Prong Boardlock #4-40 unc Screwlock Fixed
- 2S=Riveted W/2-Prong Boardlock #4-40 unc Screwlock Bulk-Packed
- 4S=Riveted W/4-Prong Boardlock #4-40 unc Screwlock Bulk-Packed

ELECTRICAL CHARACERISTICS:

- Contact Current Rating:3 Amperes.
- Dielectric Withstanding Voltage: AC 1000/60sec.r.m.s.
- Insulation Resistance:5000 Medohms Minimum.at DC 500V.
- Contact Resistance:25 Milliohms Maximum.
- Operating Temperature:-55°C to+105°C.

MECHANICAL CHARACTERISTICS:

- Contact Insertion Force:341 g.Maximum.
- Contact Separation Force:21 g.Minimum.

MATERIALS:

- Contacts:Brass.
- Insulator: PBT UL 94V-0 Rated.
- Shell:Cold Roller Steel.

RoHS COMPLIANT

HO CHIEN ENTERPRISE CO. LTD

TITLE : D-SUB RIGHT ANGLE SLIM TYPE (STAMPED CONTACT)

DR: RON CHEN	CHK: J.T.CHEN	APPD: C.Y.LIN	PAGE: 1 OF 1	HO CHIEN P/N. 3013S SERIES
--------------	---------------	---------------	--------------	----------------------------