

**HCME040-508**

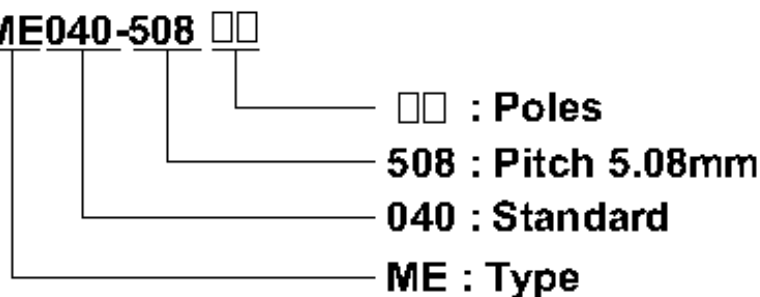

### PCB Layout

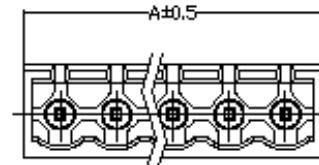
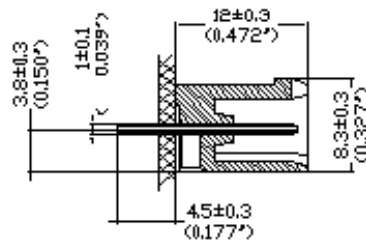
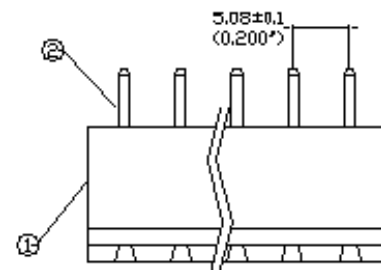
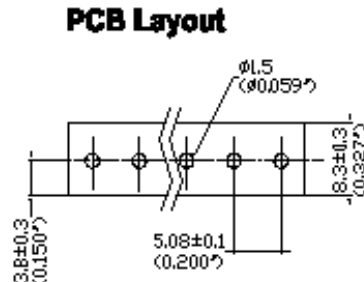

### Material

Solder Pin: 1.0mm, Brass, Tin plated  
 Insulating Body: Polyamide 66 (UL94V-0)  
 Color: Green

### Environmental

Operation temperature:  $-55^{\circ}$  to  $105^{\circ}$   
 Short-time temperature: up to  $250^{\circ}$  (482 $^{\circ}$ )

### Electrical

Current rating: 12 Amp AC300V  
 Insulation Withstands Volt: AC2000V min  
 Insulation resistance:  $>5000\text{MO}$  DC500V  
 PCB hole Dia.:  $\phi 1.5\text{mm}$